

**AERONAUTICAL  
INFORMATION  
CIRCULAR (AIC)****H13/22****Effective: 202204140600 UTC**AERONAUTICAL INFORMATION SERVICE,  
AIRSERVICES AUSTRALIA, GPO BOX 367,  
CANBERRA ACT 2601For DISTRIBUTION queries, contact:  
Email: [aim\\_editorial@airservicesaustralia.com](mailto:aim_editorial@airservicesaustralia.com)For CONTENT queries regarding this AIC, contact:  
Email: [airfield.support@melair.com.au](mailto:airfield.support@melair.com.au) Phone: 03 8326 2525**MELBOURNE AIRPORT (YMML)  
TAXIWAY TANGO AND TAXIWAY ALPHA  
INTERSECTION CLOSURE –  
TAXIWAY RESTRICTIONS****1. INTRODUCTION**

- 1.1 This AIC is intended to provide notification to aircraft and ground operations in regard to the closure of the TWY ALPHA and TWY TANGO intersection as part of the Melbourne Airport Pavement Maintenance Program and associated restrictions. Refer MOWP YMML 2020-2 Melbourne Airport Pavement Maintenance Program which can be accessed on the Melbourne Airport website.
- 1.2 Stage 14 has been modified from the original MOWP YMML 2020-2 to facilitate the replacement of concrete slabs that are in a poor or failed condition. Works will also include all civil and electrical works required in the works areas.
- 1.3 Works on Stage 14 have commenced with Version 5 of the MOWP (refer Appendix 1) to be commenced no earlier than 19 of April 2022 and are scheduled to be completed by the end of September 2022 (estimated).

**2. ADDITIONAL STAGES AND OPERATIONAL IMPACT**

- 2.1 Stage 14 is a full closure of the TWY ALPHA and TWY TANGO intersection. TWY ALPHA between TWY ECHO and TWY TANGO will not be available. TWY TANGO between TWY SIERRA and TWY FOXTROT will not be available. TWY SIERRA between TWY ECHO AND TANGO will not be available to aircraft above a 65M WINGSPAN.

- 2.2 Stage 14 will require A380 aircraft to be towed into and out of parking positions D9, D11, D13 and D15. A380 parking on D16 and D14 is preferred during this stage.
- a) For A380 arrivals into parking positions D9, D11, D13 and D15, aircraft are required to shut down on Taxiway Echo prior to Taxiway Sierra and be towed into the assigned parking position. Refer example in Appendix 2.
  - b) For A380 departures from parking positions D9, D11, D13 and D15, aircraft are required to pushback tail east, and then be pulled forward onto Taxiway Sierra (tail south) but prior to Taxiway Echo. Refer example in Appendix 3.
  - c) Subsequent ATC directions with regard to these movements must be followed.
- 2.3 Any changes to these MOWP stages or operational restrictions will be communicated via NOTAM. This AIC will also be subject to amendment as required

### **3. CANCELLATION**

- 3.1 This AIC will be cancelled when the works are completed.

### **4. DISTRIBUTION**

- 4.1 Airservices Australia website only.

### **Appendices**

1. MOWP 2020/2 - Stage 14 works area
2. A380 arrival example (Stage 14) - tow connect location
3. A380 Departures example (Stage 14) - tow disconnect location

1. MOWP 2020/2 - Stage 14 works area

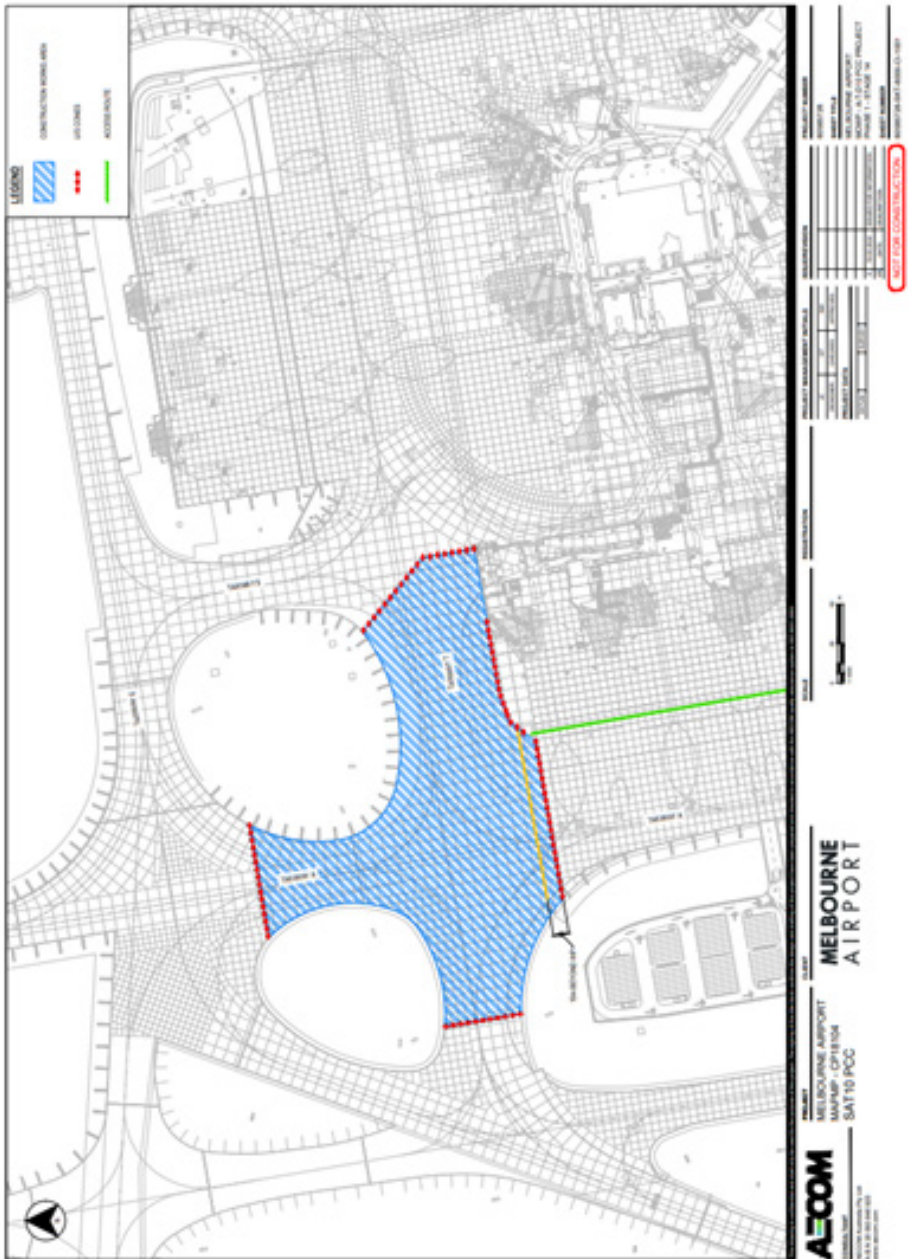

2. A380 arrival example (Stage 14) - tow connect location

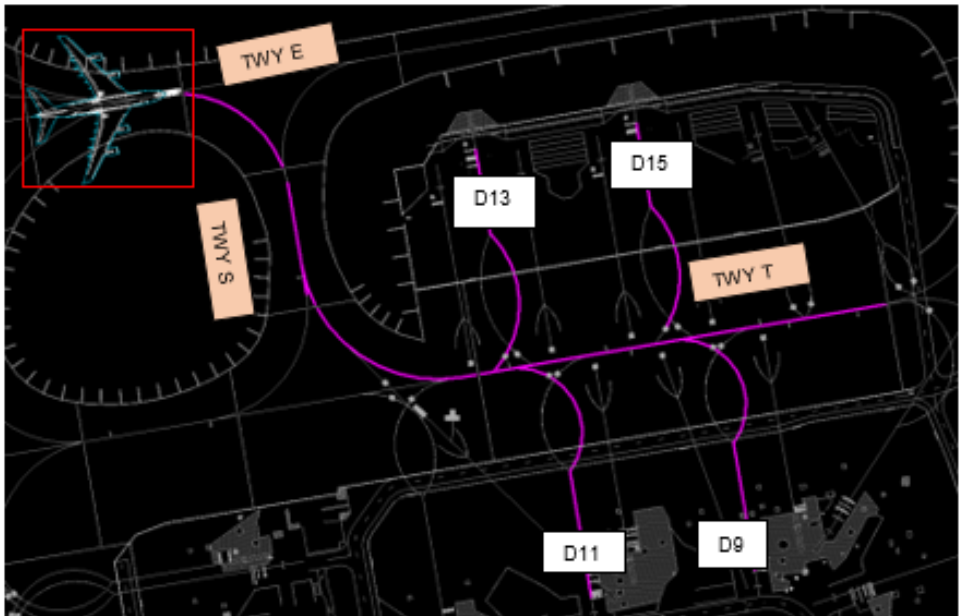

3. A380 Departures example (Stage 14) - tow disconnect location

